



# 100 SERIES (NON-EJECTOR) WATER COOLED ELECTRODE HOLDER

Phone: 888-654-9353 Fax: 937-253-2324 Production Engineering Sales Co.

## 100 SERIES (NON-EJECTOR) WATER COOLED ELECTRODE HOLDER

100 SERIES TAPERED HOLDER					
Part No. Holder Assy.	Major Taper Dia. A	Barrel Dia. B	Barrel Length C	RW Taper D	Engagement With Std. Elect. E
18-101	.463	3/4	3	4 RW	1/2
18-102		7/8			
18-103		1			
18-104		1-1/4			
18-106	.625	1	8	5 RW	3/4
18-107		1-1/4			
18-108		1-1/2			
18-111	.463	3/4	12	4 RW	1/2
18-112		7/8			
18-113		1			
18-114		1-1/4			
18-116	.625	1	8	5 RW	3/4
18-117		1-1/4			
18-118		1-1/2			
18-119	.875	1-1/4	12	7 RW	1-1/8
18-120		1-1/2			
18-131	.463	3/4	3	4 RW	1/2
18-132		7/8			
18-133		1			
18-134		1-1/4			
18-136	.625	1	8	5 RW	3/4
18-137		1-1/4			
18-138		1-1/2			

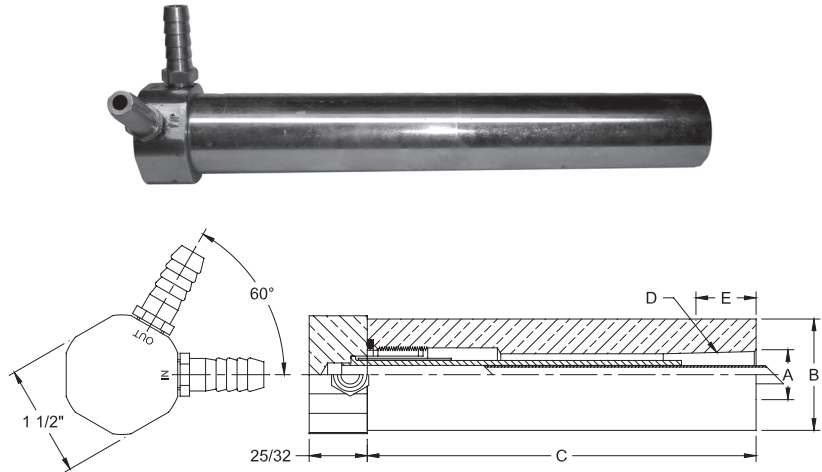

100 SERIES THREADED HOLDER				
Part No. Holder Assy.	Barrel Dia. B	Barrel Length C	Thread Size D	Engagement With Std. Electrode E
18-169	1	8	5/8-18	9/16
18-170	1-1/4			
18-171	1-1/2			
18-172	1	12	7/8-14	9/16
18-173	1-1/4			
18-174	1-1/2			
18-175	1-1/4	12	1-14	3/4
18-176	1-1/2			

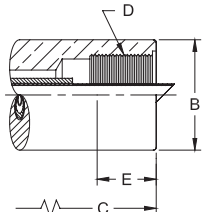

See available adapters in table below.

## ADAPTERS USED WITH THREADED HOLDERS

100 SERIES THREADED HOLDER ADAPTERS					
Holder Assembly No.	Adapter Part No.	Page No.	Attachment Description		
18-169 18-170 18-171	Use with 18-750 18-751 18-752 18-811	31	4 RW Female		
		31	5 RW Female		
		31	5/8-18 M. Thread		
		48	#1 Size Nu-Twist®		
18-172 18-173 18-174	Use with 18-770 18-771	31	4 RW Female	May also be used with universal Adapters having 7/8-14 Male thread See page 46	
		31	5 RW Female		
18-175 18-176	Use with 18-785 18-786 18-7863 18-787 18-812	31	4 RW Female	May also be used with universal Adapters having 1-14 Male thread See page 46	
		31	5 RW Female		
		31	6 RW Female		
		31	7 RW Female		
		48	#2 Size Nu-Twist®		

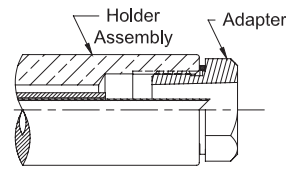
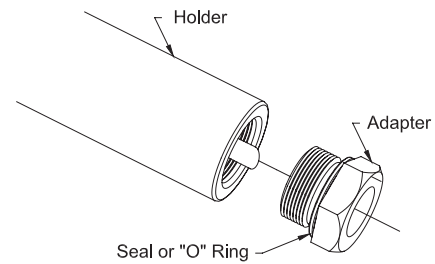

# 500 SERIES THREADED PREMIUM (EJECTOR) REPLACEMENT PARTS



Phone: 888-654-9353 Fax: 937-253-2324 Production Engineering Sales Co.

## 500 SERIES PREMIUM (EJECTOR) WATER COOLED OFFSET HOLDERS WITH THREADED ADAPTER

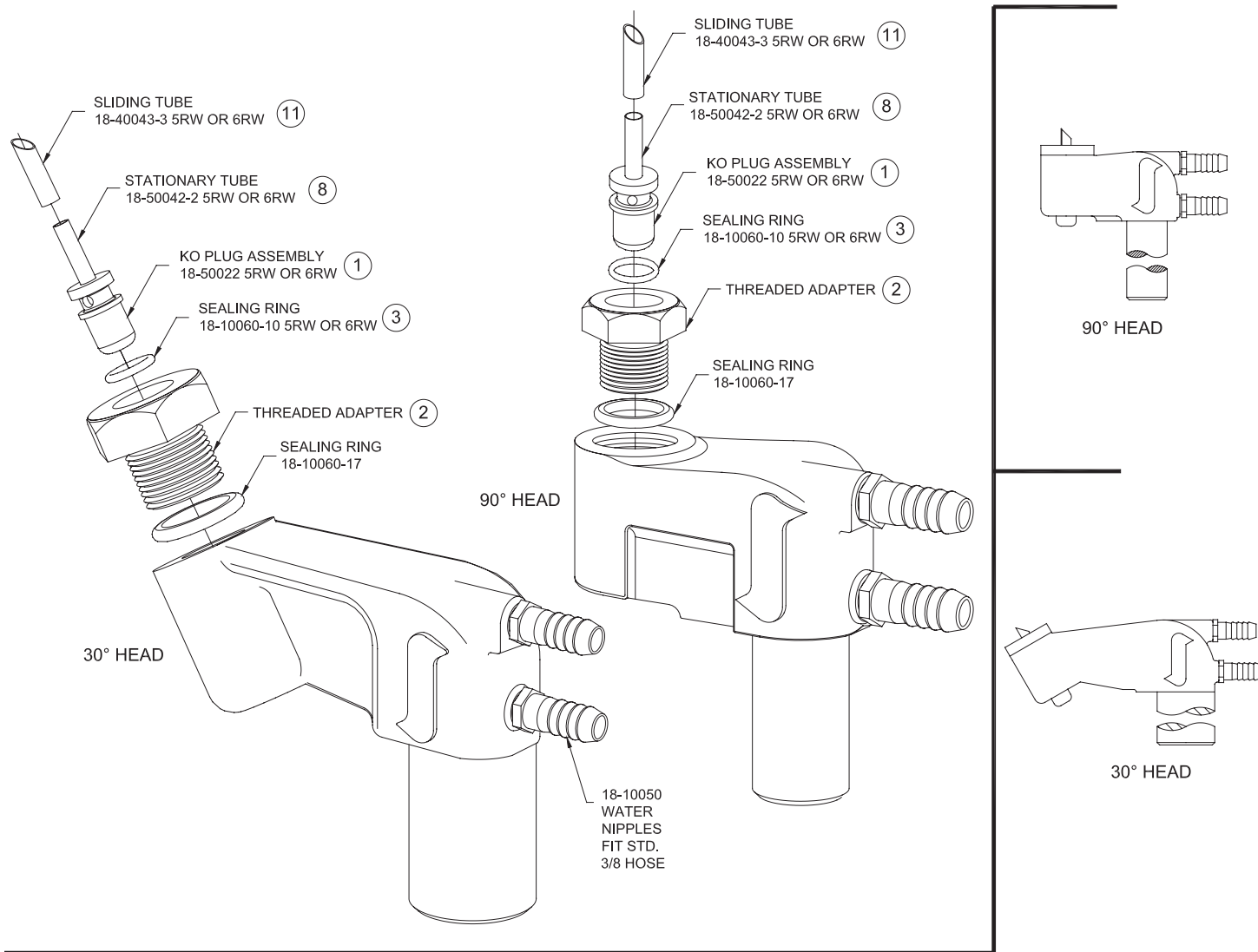

Part No. Holder Assy.	Taper	Angle Of Head	KO Plug ** 1	Sealing Ring 3	Stationary Tube 8	Sliding Tube 11	Shank Dia.	Threaded Adapter* 2
18-5035 18-5036	5 RW 6 RW	90°	18-50022	18-10060-10	18-50042-2	18-40043-3	1-1/4	18-7875 18-7876
18-5045 18-5046	5 RW 6 RW	90°	18-50022	18-10060-10	18-50042-2	18-40043-3	1-1/2	18-7875 18-7876
18-5235 18-5236	5 RW 6 RW	90°	18-50022	18-10060-10	18-50042-2	18-40043-3	1-1/4	18-7875 18-7876
18-5245 18-5246	5 RW 6 RW	90°	18-50022	18-10060-10	18-50042-2	18-40043-3	1-1/2	18-7875 18-7876
18-5635 18-5636	5 RW 6 RW	30°	18-50022	18-10060-10	18-50042-2	18-40043-3	1-1/4	18-7875 18-7876
18-5645 18-5646	5 RW 6 RW	30°	18-50022	18-10060-10	18-50042-2	18-40043-3	1-1/2	18-7875 18-7876

\* Threaded adapter includes sealing ring 18-10060-17

\*\* KO Plug assembly includes stationary tube 18-50042-2



# 300 SERIES PREMIUM (EJECTOR) WATER COOLED ELECTRODE HOLDERS

Phone: 888-654-9353 Fax: 937-253-2324 Production Engineering Sales Co.

## 300 SERIES PREMIUM (EJECTOR) WATER COOLED ELECTRODE HOLDER

CMW Premium holder barrels are made from high strength CMW<sup>®3</sup> material, centerless ground within .002" tolerance on diameter and nickel plated to resist wear and assure uniform contact resistance of a low magnitude



300 SERIES TAPERED HOLDER					
Part No. Holder Assy.	Major Taper Dia. A	Barrel Dia. B	Barrel Length C	RW Taper D	Engagement With Std. Elect. E
18-317 18-318	.625	1-1/4 1-1/2	8	5 RW	3/4
18-319* 18-320*	.875	1-1/4 1-1/2		7 RW	1-1/8
18-337 18-338	.625	1-1/4 1-1/2	12	5 RW	3/4
18-339* 18-340*	.875	1-1/4 1-1/2		7 RW	1-1/8

\*Must use knockout adapter 18-20033

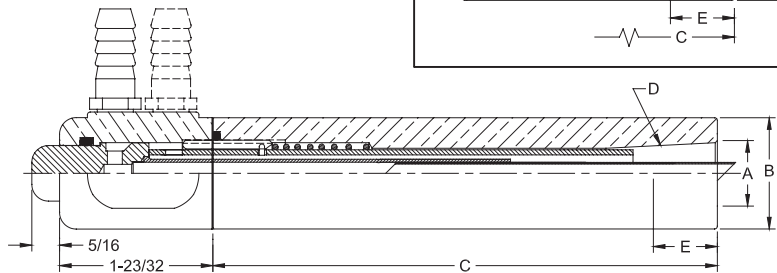
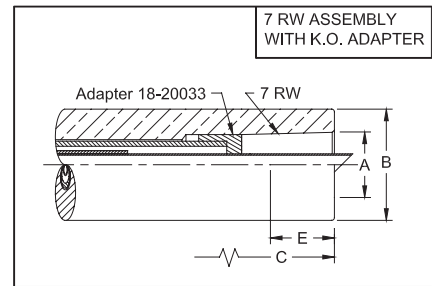
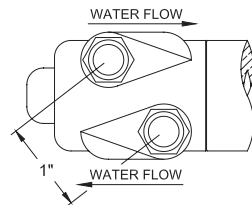

300 SERIES THREADED HOLDER				
Part No. Holder Assy.	Barrel Dia. B	Barrel Length C	Thread Size D	Engagement With Std. Elect. E
18-372 18-373	1 1-1/4	8	7/8-14	9/16
18-375 18-376	1-1/4 1-1/2		1-14	3/4

300 Series Threaded Holder can use Male Threaded to Female Taper Universal Adapters on page 46.

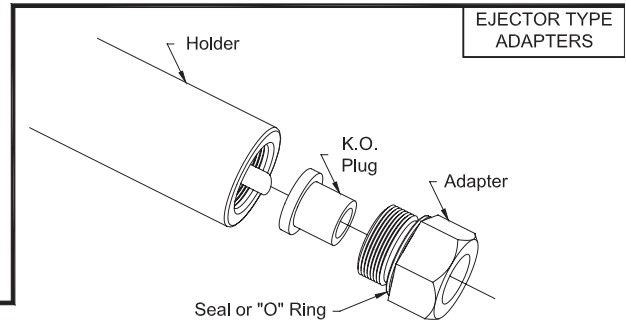
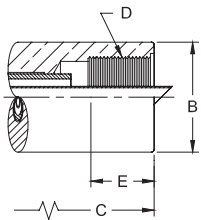

Note: These threaded holder barrels are the same as on 600 series holders on page 44.

### EJECTOR TYPE ADAPTERS

EJECTOR TYPE ADAPTERS 7/8-14 THREAD								
Adapter Part No.	Male Thd. Size L	Female Taper		Length Under Hd. M	Hex. Over Flats H		Sealing Ring Part No.	K.O. Plug Part No.
		Size D	Major Dia.		Flats	Overall Length C		
18-7702	7/8-14	4 RW	.463	5/8	1	13/16	18-76460	18-78501
18-7712	7/8-14	5 RW	.625	1/2	1	1-1/16	18-76460	18-7712-3

Use with Threaded Ejector Holder to make Replaceable Taper Holders

Part No.	Female Thd. Size	Barrel Dia.
18-372	7/8-14	1
18-373	7/8-14	1-1/4

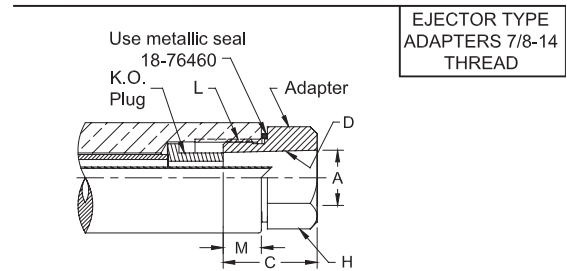

EJECTOR TYPE ADAPTERS 1-14 THREAD								
Adapter Part No.	Male Thd. Size L	Female Taper		Length Under Hd. M	Hex. Over Flats H		Sealing Ring Part No.	K.O. Plug Part No.
		Size D	Major Dia.		Flats	Overall Length C		
18-7852	1-14	4 RW	.463	9/16	1-1/4	13/16	18-10060-17	18-78501
18-7862	1-14	5 RW	.625	7/16	1-1/4	1-1/16	18-10060-17	18-7712-3
18-7864	1-14	6 RW	.750	3/4	1-1/4	1-3/4	18-10060-17	18-78650
18-7872	1-14	7 RW	.875	3/4	1-1/4	2-1/8	18-10060-17	18-78701

Use with Threaded Ejector Holder to make Replaceable Taper Holders

Part No.	Female Thd. Size	Barrel Dia.
18-375	1-14	1-1/4
18-376	1-14	1-1/2

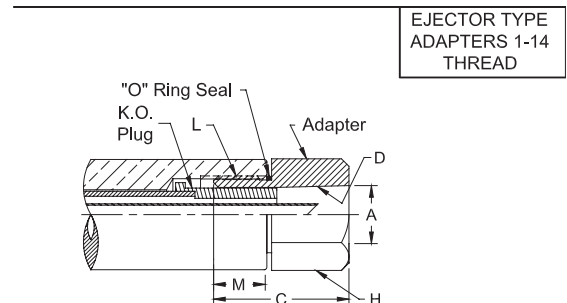



# 200 SERIES (EJECTOR) WATER COOLED ELECTRODE HOLDER

Phone: 888-654-9353 Fax: 937-253-2324 Production Engineering Sales Co.

## 200 SERIES (EJECTOR) WATER COOLED ELECTRODE HOLDER

200 SERIES TAPERED HOLDER					
Part No. Holder Assy.	Major Taper Dia. A	Barrel Dia. B	Barrel Length C	RW Taper D	Engagement With Std. Elect. E
18-201	.463	3/4	3	4 RW	1/2
18-202		7/8			
18-203		1			
18-204		1-1/4			
18-206	.625	1	8	5 RW	3/4
18-207		1-1/4			
18-208		1-1/2			
18-211	.463	3/4	12	4 RW	1/2
18-212		7/8			
18-213		1			
18-214		1-1/4			
18-216	.625	1	8	5 RW	3/4
18-217		1-1/4			
18-218		1-1/2			
18-219*	.875	1-1/4	12	7 RW	1-1/8
18-220*		1-1/2			
18-231	.463	3/4	18	4 RW	1/2
18-232		7/8			
18-233		1			
18-234		1-1/4			
18-236	.625	1	18	5 RW	3/4
18-237		1-1/4			
18-238		1-1/2			
18-236-18	.625	1	18	5 RW	3/4
18-237-18		1-1/4			
18-238-18		1-1/2			

\*Must use knockout adapter 18-20033

200 SERIES THREADED HOLDER				
Part No. Holder Assy.	Barrel Dia. B	Barrel Length C	Thread Size D	Engagement With Std. Elect. E
18-272	1	8	7/8-14	9/16
18-273	1-1/4			
18-274	1-1/2			
18-275	1-1/4	8	1-14	3/4
18-276	1-1/2			

200 Series Threaded Holder can use Male Threaded to Female Taper Universal Adapters on page 46.

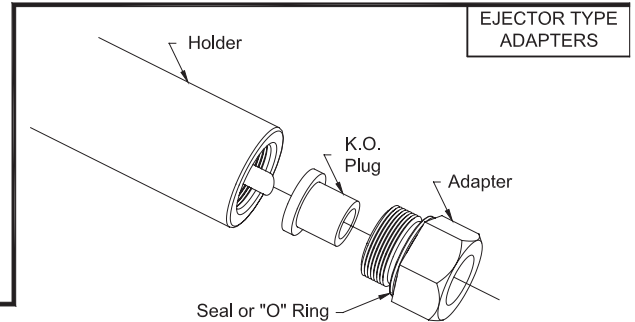
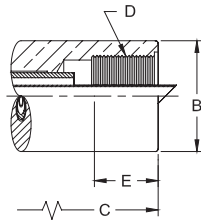
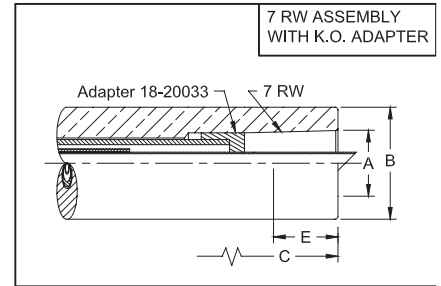
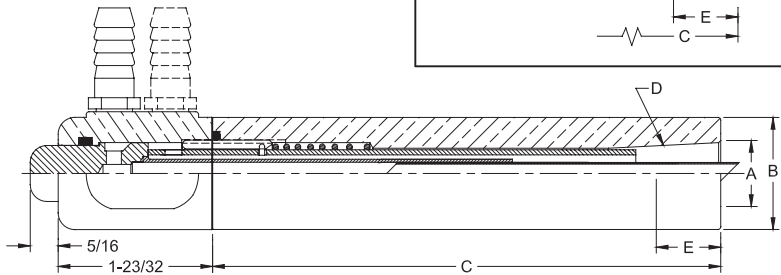
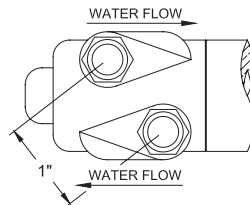

### EJECTOR TYPE ADAPTERS

EJECTOR TYPE ADAPTERS 7/8-14 THREAD								
Adapter Part No.	Male Thd. Size L	Female Taper		Length Under Hd. M	Hex. Over Flats H	Overall Length C	Sealing Ring Part No.	K.O. Plug Part No.
		Size D	Major Dia. A					
18-7702	7/8-14	4 RW	.463	5/8	1	13/16	18-76460	18-78501
18-7712	7/8-14	5 RW	.625	1/2	1	1-1/16	18-76460	18-7712-3

Use with Threaded Ejector Holder to make Replaceable Taper Holders

Part No.	Female Thd. Size	Barrel Dia.
18-272	7/8-14	1
18-273	7/8-14	1-1/4
18-274	7/8-14	1-1/2

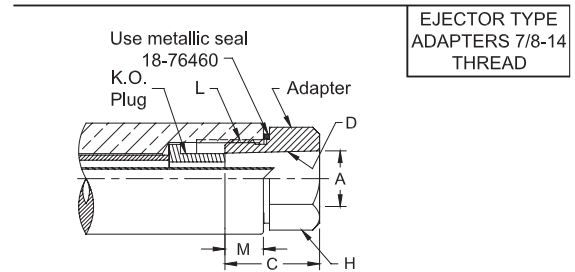

EJECTOR TYPE ADAPTERS 1-14 THREAD								
Adapter Part No.	Male Thd. Size L	Female Taper		Length Under Hd. M	Hex. Over Flats H	Overall Length C	Sealing Ring Part No.	K.O. Plug Part No.
		Size D	Major Dia. A					
18-7852	1-14	4 RW	.463	9/16	1-1/4	13/16	18-10060-17	18-78501
18-7862	1-14	5 RW	.625	7/16	1-1/4	1-1/16	18-10060-17	18-7712-3
18-7864	1-14	6 RW	.750	3/4	1-1/4	1-3/4	18-10060-17	18-78650
18-7872	1-14	7 RW	.875	3/4	1-1/4	2-1/8	18-10060-17	18-78701

Use with Threaded Ejector Holder to make Replaceable Taper Holders

Part No.	Female Thd. Size	Barrel Dia.
18-275	1-14	1-1/4
18-276	1-14	1-1/2

